

**A PRODUCT OF OUR LINE ULTRA+**

**Chemical protection at highest level,  
 with very best permeation properties**

**ChemResist ETFE ultra+ EVOLUTION**

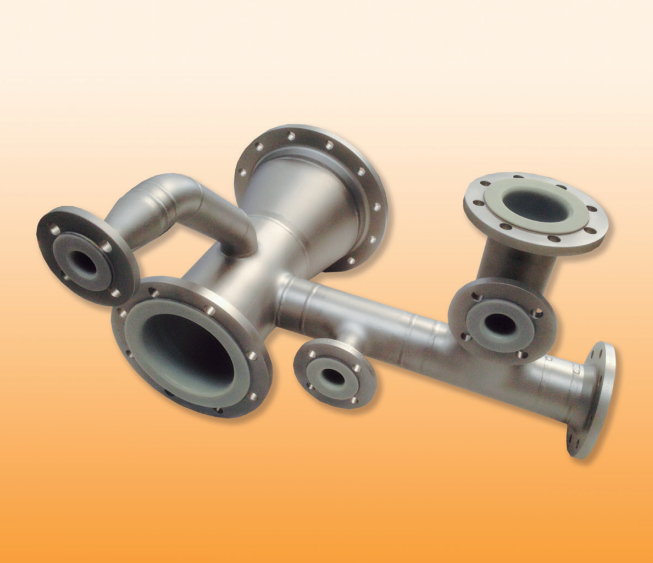

The material for this Fluoropolymer-coating, that will be applied with the Rotational-Sinter-Lining-Technology is highly resistant against chemicals and acids, and has extraordinarily advantages, compared with common coating and lining systems:

- Fully automated Rotational-Sinter-Lining-Technology for highest demands
- Seamless lining for almost all designs
- Excellent bonding to substrate
- Compared with conventional Fluoropolymer-Linings outstanding features in permeation by using filler
- Layer thickness up to 5 mm

**ChemResist ETFE ultra+ EVOLUTION**

- Exceptional, universal chemical resistance at high temperatures
- Excellent when proven under clean room conditions
- Also available in electrical conductive version
- Locally repairable
- Solvent-resistant
- Easy to clean, excellent non-stick properties
- Non flammable
- Cold resistant
- Suitable for vacuum
- FDA- and EU-compliant

**RUDOLF GUTBROD GmbH**

Im Schwöllbogen 10, 72581 Dettingen/Erms, Germany, Tel. +49 (0)71 23 - 97 35-0  
 www.gutbrod-ptfe.de, e-mail: info@gutbrod-ptfe.de



All statements, information and data are given to the best of our knowledge. A guarantee, obligation or liability cannot be derived from this in any way. Gutbrod reserves the right to make changes to the product range and to product extensions. EN\_11/2017